

Louis Braille and his Braille Printing

- ❖ Braille printing was originally developed by Louis Braille.
- ❖ Braille printing is read principally from left to right.
- ❖ The basis of the Braille printing is built upon six points as of dice.
- ❖ All symbols are consisted of combinations of these points.
- ❖ There are 64 different symbols from the ordinary 6-points-Braille printing.
- ❖ Normal 6-points-Braille printing is approx. 6 - 7 mm in height and approx. 4 - 5 mm in width.

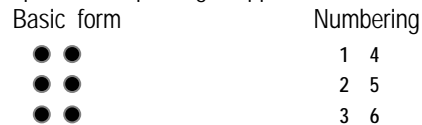

❖ Representation of numbers: The numbers are formed by the letters a to j with the number sign placed in front.

- ❖ The directly following word after the number sign is to be read as number.
- ❖ The number sign corresponds to the , # ' symbol in the Braille labeller.

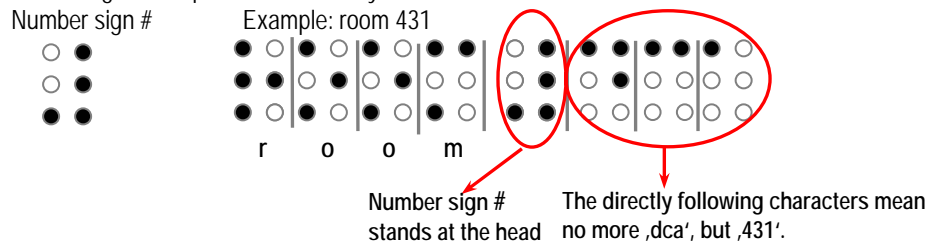

Some important words:

Advice: For simplification, capital letters and abbreviations are being avoided..

- entrance: entrance
- exit: exit
- stairs: stairs
- room 18: room # 1 8
- emergency exit: emergency exit
- toilette: toilette
- ladies: ladies
- gents: gents

Alphabet in brief view

A ₁	B ₂	C ₃	D ₄	E ₅	F ₆
G ₇	H ₈	I ₉	J ₀	K	L
M	N	O	P	Q	R
S	T	U	V	W	X
Y	Z				

Operating manual of braille labeller



1. Braille labeller and tape. Each band should be longer than 9,5 cm, so the Label can fill into the labelling area on the door handle.

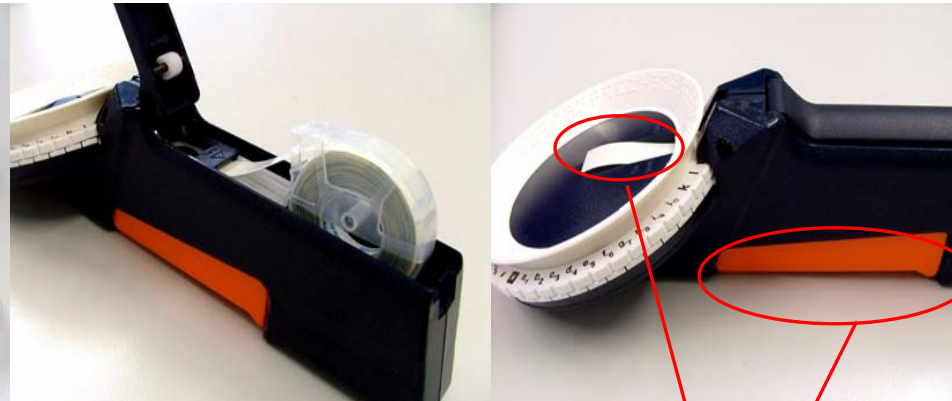

2. Open the tape case, lay in the tape, leave the band about 3cm under the marked symbol. Close the case.



3. Press slightly the orange button a few times, till the plastic band coming out.

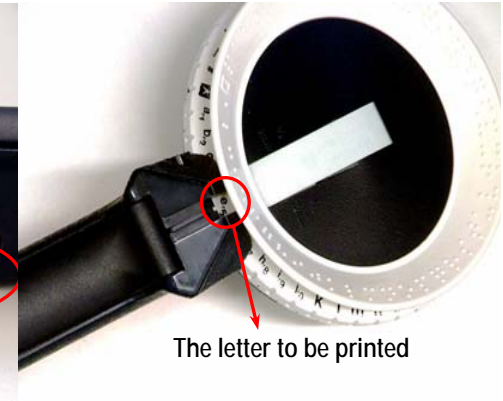

4. Rotate the circle till the wished letters showing in the small window. Press the orange button firmly, the wanted letter will be printed out.



5. Repeat step 4, till the wanted word is completely printed out. **Do not use any abbreviation on labeller!** Draw out the band min. 9,5cm lang, so the label can fill into the labelling area.



6. **Important before cutting:** Please mark the first letter on the backside of the label to avoid possible mistakes. The labelling area on the door handle enable max. 15 letters including space and symbols.

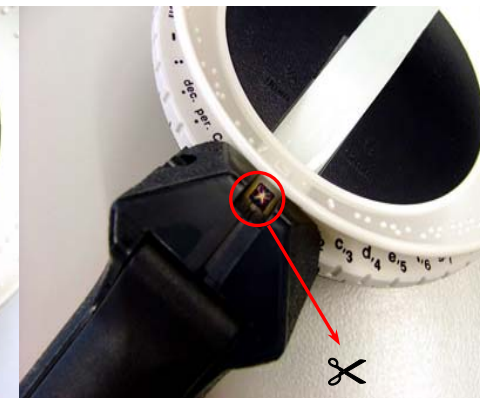

7. To disconnect the label: Rotate the circle till the cutting symbol shows. Press the orange Taste firmly, then pull out label and cut the label to exactly 9,5cm with a scissor.

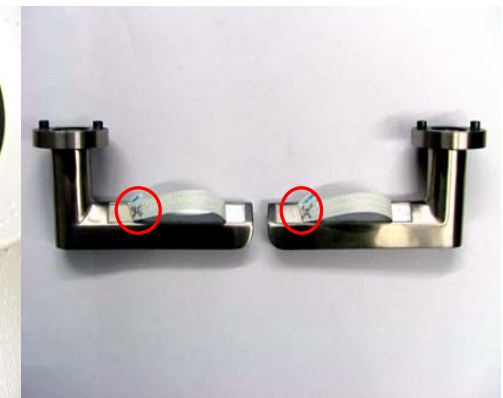

8. Label pasting: Lay the door handles in front of yourself as shown in photo, the mark should be on the left side. Clean the labelling area carefully, take off the sticker on the back, paste, finished!

Our suggestion: 1. All the door handles should be labelled before assembly, they should be clearly notified on the package.

2. Pay attention to pairwise different labels on the DIN-direction!