

Assembly Instructions for letter plate

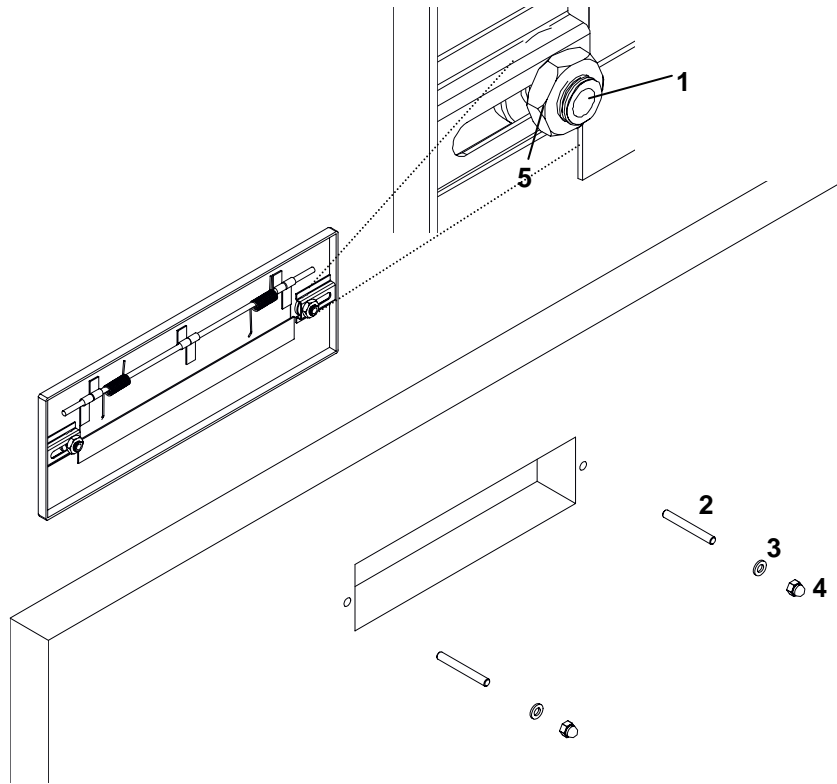

1. The opening slot in the door has to be 230mm x 60mm to allow smooth operation of the letter plate flap.
2. Drill two holes (\varnothing 7mm) horizontally through the door at the required interval (247-280mm).
3. Take the letter plate and turn in the M6 threaded bolts (2) into the threaded retainers (1).
4. Set the distance of the threaded bolts (2) so that they correspond with the existing door drills and fix it with the hex nut (5)
5. Insert the threaded bolts (2) through the door. Check that the protruding length of bolts is 5-6mm on the opposite side. Cut the bolts if necessary.
6. Put the washers on first, followed by the cap nut and tighten.
7. Check for smooth operation