

New York

Finish: satin/polished stainless steel (73)

New York on rose, special door prep required



New York – TER65Q
 2 1/16" x 2 1/16"

product code
 square

| | |
|----------------|------------------------|
| TER65Q LA60 73 | passage 2 3/8" backset |
| TER65Q LA70 73 | passage 2 3/4" backset |
| TER65Q DUM 73 | full dummy |
| TER65Q DUML 73 | half dummy left |
| TER65Q DUMR 73 | half dummy right |
| UEZ1340 PB 73 | privacy bolt |

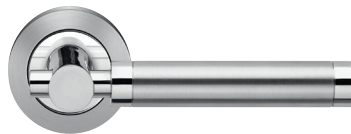

New York – TER65
 Ø 2 1/16" x 7/16"

round

| | |
|---------------|------------------------|
| TER65 LA60 73 | passage 2 3/8" backset |
| TER65 LA70 73 | passage 2 3/4" backset |
| TER65 DUM 73 | full dummy |
| TER65 DUML 73 | half dummy left |
| TER65 DUMR 73 | half dummy right |
| UEZ1332 PB 73 | privacy bolt |

Features TER65Q and TER65

- 3 piece rose
- concealed bolt-through fixing
- sprung
- door range 1 1/2" (38 mm) - 1 7/8" (48 mm) standard
- T- and Lip-Strike with dust box
- stainless steel faceplate
- backsets: 2 3/8" (60 mm) or 2 3/4" (70 mm)
- functions: Passage (LA), full dummy (DUM), dummy left (DUML), dummy right (DUMR)
- available with UL-Latch
- 28° latch with attached face plate
- rate of satin stainless steel 304
- hub 5/16" (8 mm)
- available finishes: satin/polished stainless steel, satin stainless steel

specification details

lever

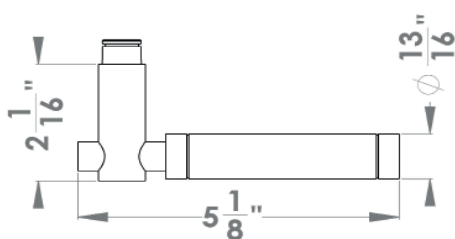

round rose

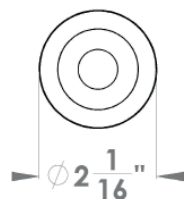

square rose

