



Torino

Finish: satin nickel (60) / inlay ebony (HS)

Torino on rose, special door prep required



Torino – TR53Q

2 1/16" x 2 1/16"

product code square

TR53Q LA60 60 ... passage 2 3/8" backset
 TR53Q LA70 60 ... passage 2 3/4" backset
 TR53Q DUM 60 ... full dummy
 TR53Q DUML 60 ... half dummy left
 TR53Q DUMR 60 ... half dummy right
 UEZ1340 PB 71 privacy bolt



Torino – TR53

Ø 2 1/16" x 7/16"

round

TR53 LA60 60 ... passage 2 3/8" backset
 TR53 LA70 60 ... passage 2 3/4" backset
 TR53 DUM 60 ... full dummy
 TR53 DUML 60 ... half dummy left
 TR53 DUMR 60 ... half dummy right
 UEZ1332 PB 71 privacy bolt

Features TR53Q and TR53

- 3 piece rose
- concealed bolt-through fixing
- sprung
- door range 1 1/2" (38 mm) - 1 7/8" (48 mm) standard
- T- and Lip-Strike with dust box
- stainless steel faceplate
- backsets: 2 3/8" (60 mm) or 2 3/4" (70 mm)
- functions: Passage (LA), full dummy (DUM), dummy left (DUML), dummy right (DUMR)
- 28° latch with attached face plate
- hub 5/16" (8 mm)
- available finishes: satin nickel, chrome

laminate and carbon

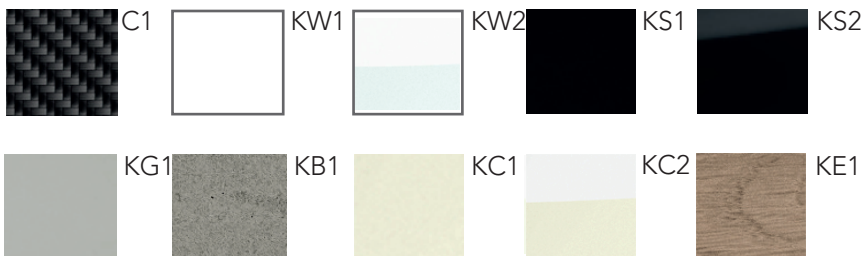

C1: real carbon
 KW1: white
 KW2: shining white
 KS1: black
 KS2: shining black
 KG1: grey
 KB1: concrete texture
 KC1: cream white
 KC2: shining cream white
 KE1: light oak texture

leather



LH: light brown leather
 LD: dark brown leather
 LS: black leather

wood



HS: ebony
 HE1: light oak
 HE2: rustic oak

specification details

lever

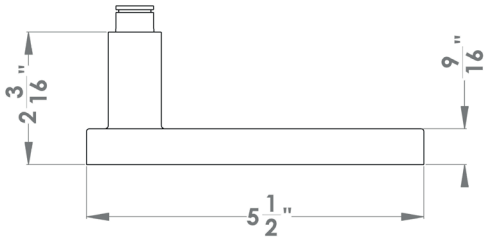

round rose

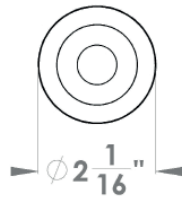

square rose

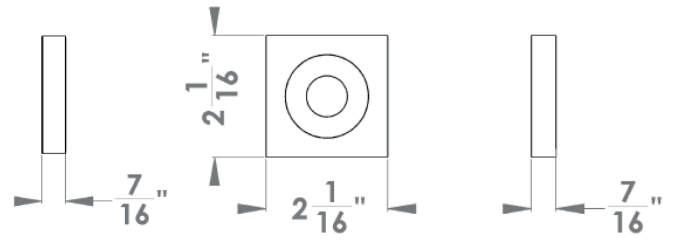

Please note: Karcher Design products are designed and measured in metric. Imperial measurements are close approximations to the actual metric dimensions.