

Tear Sheet for Mortise set
Model Atlantis on rose by KARCHER DESIGN



contact our US office
Karcher Design USA
Tukwila, Seattle
+1 844 858 2033
order@karcher-design.com



Atlantis

Finish: polished/satin stainless steel (73)

Atlantis on Rose, special door prep required



Atlantis- TER 36Q
2 1/16" x 2 1/16"



Atlantis- TER 36
Ø 2 1/16" x 7/16"

Features TER36Q and TER36

- 3 piece rose
- concealed bolt-through fixing
- sprung
- door range 1 1/2" (38 mm) - 1 7/8" (48 mm) standard
- stainless steel faceplate
- Accurate UL Listed Mortise Lock
- available with UL-Latch
- rate of satin stainless steel 304
- hub 5/16" (8 mm)
- available finish: polished/satin stainless steel

Product code Mortise set square

TER36Q PRI 9139 73	Accurate privacy without cylinder
TER36Q STORE 9195 73	Accurate storeroom/nitelatch
TER36Q ENT 9167 73	Accurate entrance set without cylinder
TER36Q ENT 9169 73	Accurate entrance set without cylinder
UEZ1340 CC 73	cylinder colar
UEZ1340 TT 73	thumbturn
UEZ1340 BAD 73	privacy thumbturn

round

TER36 PRI 9139 73	Accurate privacy without cylinder
TER36 STORE 9195 73	Accurate storeroom/nitelatch
TER36 ENT 9167 73	Accurate entrance set without cylinder
TER36 ENT 9169 73	Accurate entrance set without cylinder
UEZ1332 CC 73	cylinder colar
UEZ1332 TT 73	thumbturn
UEZ1332 BAD 73	privacy thumbturn

specification details

lever

round rose

square rose

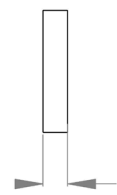
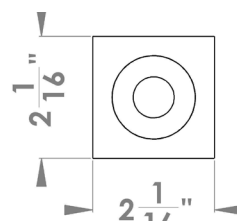
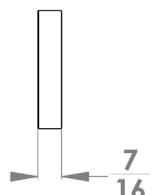
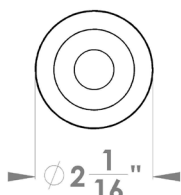
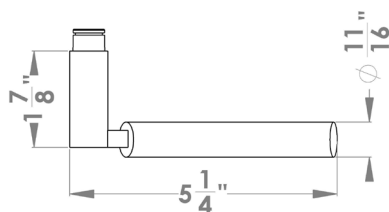

Please note: Karcher Design products are designed and measured in metric. Imperial measurements are close approximations to the actual metric dimensions