

Tear Sheet for Mortise set
Model Elba on rose by KARCHER DESIGN

KARCHER
DESIGN
GERMANY

contact our US office
Karcher Design USA
Tukwila, Seattle
+1 844 858 2033
order@karcher-design.com

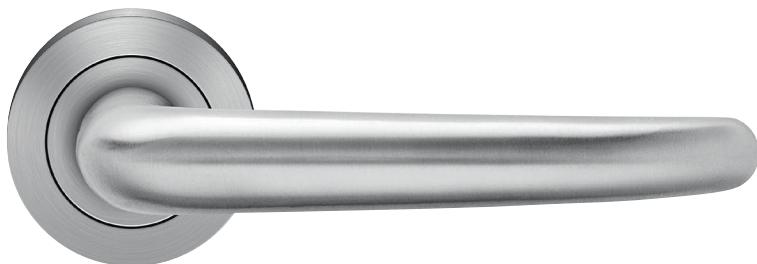

Elba

Finish: Satin stainless steel (71)

Elba on Rose, special door prep required



Elba- TER 22Q
2 1/16" x 2 1/16"



Elba- TER 22
Ø 2 1/16" x 7/16"

Features TER22Q and TER22

- 3 piece rose
- concealed bolt-through fixing
- sprung
- door range 1 1/2" (38 mm) - 1 7/8" (48 mm) standard
- stainless steel faceplate
- Accurate UL Listed Mortise Lock
- available with UL-Latch
- rate of satin stainless steel 304
- hub 5/16" (8 mm)
- available finish: satin stainless steel

Product code Mortise set

square

TER22Q PRI 9139 71 Accurate privacy without cylinder
TER22Q STORE 9195 71 Accurate storeroom/nitelatch
TER22Q ENT 9167 71 Accurate entrance set without cylinder
TER22Q ENT 9169 71 Accurate entrance set without cylinder
UEZ1340 CC 71 cylinder colar
UEZ1340 TT 71 thumbturn
UEZ1340 BAD 71 privacy thumbturn

round

TER22 PRI 9139 71 Accurate privacy without cylinder
TER22 STORE 9195 71 Accurate storeroom/nitelatch
TER22 ENT 9167 71 Accurate entrance set without cylinder
TER22 ENT 9169 71 Accurate entrance set without cylinder
UEZ1332 CC 71 cylinder colar
UEZ1332 TT 71 thumbturn
UEZ1332 BAD 71 privacy thumbturn

specification details

lever

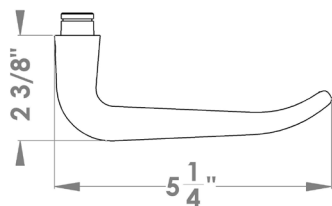

round rose

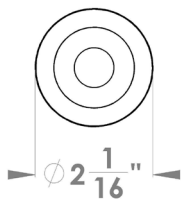

square rose

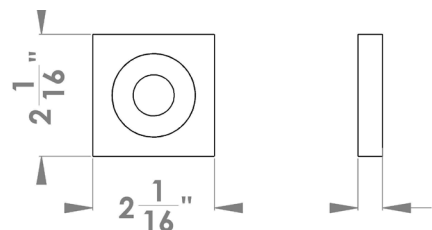

Please note: Karcher Design products are designed and measured in metric. Imperial measurements are close approximations to the actual metric dimensions