

Manhattan

Finish: satin stainless steel (71)

Manhattan on rose, special door prep required



Manhattan – TER21Q
2 1/16" x 2 1/16"



Manhattan – TER21
Ø 2 1/16" x 7/16"

Features TER21Q and TER21

- 3 piece rose
- concealed bolt-through fixing
- sprung
- door range 1 1/2" (38 mm) - 1 7/8" (48 mm) standard
- stainless steel faceplate
- Accurate UL Listed Mortise Lock
- rate of satin stainless steel 304
- hub 5/16" (8 mm)
- available finishes: satin stainless steel, cosmos black

product code

square

TER21Q PRI 9139 71 Accurate privacy without cylinder
TER21Q STORE 9195 71 Accurate storeroom/nitelatch
TER21Q ENT 9167 71 Accurate entrance set;
cylinder not included

TER21Q ENT 9169 71 Accurate entrance set;
cylinder not included

UEZ1340 CC 71 cylinder collar
UEZ1340 TT 71 thumbturn
UEZ1340 BAD 71 privacy thumbturn

round

TER21 PRI 9139 71 Accurate privacy without cylinder
TER21 STORE 9195 71 Accurate storeroom/nitelatch
TER21 ENT 9167 71 Accurate entrance set;
cylinder not included

TER21 ENT 9169 71 Accurate entrance set;
cylinder not included

UEZ1332 CC 71 cylinder collar
UEZ1332 TT 71 thumbturn
UEZ1332 BAD 71 privacy thumbturn

specification details

lever

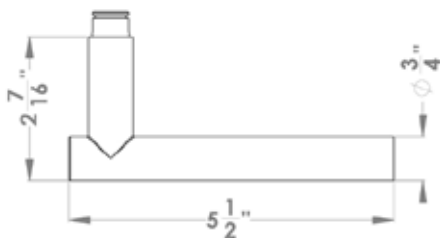

round rose

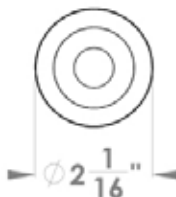

square rose

