

Tear Sheet for Mortise set
Model New York on rose by KARCHER DESIGN



contact our US office
Karcher Design NA
1042 Industry Dr.
Tukwila, WA 98188
Office: 844-858-2033
Fax 253-236-4469
order@karcher-design.com
www.karcher-design.com



New York

Finish: satin/polished stainless steel (73)

New York on rose, special door prep required



New York – TER65Q
2 1/16" x 2 1/16"



New York – TER65
Ø 2 1/16" x 7/16"

Features TER65Q and TER65

- 3 piece rose
- concealed bolt-through fixing
- sprung
- door range 1 1/2" (38 mm) - 1 7/8" (48 mm) standard
- stainless steel faceplate
- Accurate UL Listed Mortise Lock
- rate of satin stainless steel 304
- hub 5/16" (8 mm)
- available finishes: satin/polished stainless steel, satin stainless steel

product code

square

TER65Q PRI 9139 73 Accurate privacy without cylinder
TER65Q STORE 9195 73 Accurate storeroom/nitelatch
TER65Q ENT 9167 73 Accurate entrance set;
cylinder not included
TER65Q ENT 9169 73 Accurate entrance set;
cylinder not included
UEZ1340 CC 73 cylinder collar
UEZ1340 TT 73 thumbturn
UEZ1340 BAD 73 privacy thumbturn

round

TER65 PRI 9139 73 Accurate privacy without cylinder
TER65 STORE 9195 73 Accurate storeroom/nitelatch
TER65 ENT 9167 73 Accurate entrance set;
cylinder not included
TER65 ENT 9169 73 Accurate entrance set;
cylinder not included
UEZ1332 CC 73 cylinder collar
UEZ1332 TT 73 thumbturn
UEZ1332 BAD 73 privacy thumbturn

specification details

lever

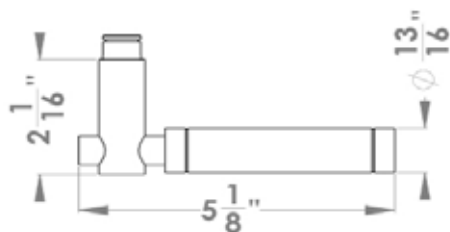

round rose



square rose

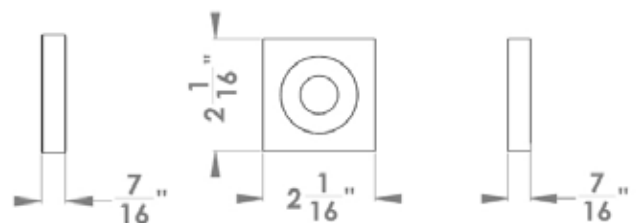

Please note: Karcher Design products are designed and measured in metric. Imperial measurements are close approximations to the actual metric dimensions