



Seattle

Finish: satin stainless steel (71)

To suit standard 2 1/8" door prep



Seattle – UER46Q
 2 5/8 x 2 5/8 x 7/16"



Seattle – UER46
 Ø 2 5/8 x 7/16"

Features UER46Q and UER46

- 3 piece rose
- concealed bolt-through fixing
- sprung
- door range 1 1/4" (31 mm) - 2" (51 mm) standard
- T- and Lip-Strike with dust box
- stainless steel faceplate
- backsets: 2 3/8" (60 mm) or 2 3/4" (70 mm)
- functions: Passage (PAS), Privacy (PRI), full dummy (DUM), dummy left (DUML), dummy right (DUMR)
- available with UL-Latch
- 28° latch with attached face plate
- rate of satin stainless steel 304
- hub 5/16" (8 mm)
- door prep 2 1/8"
- available finishes: satin stainless steel, polished stainless steel, oil rubbed bronze, cosmos black

product code
 square

UER46Q PAS60 71	passage 2 3/8" backset
UER46Q PAS70 71	passage 2 3/4" backset
UER46Q PRI60 71	privacy 2 3/8" backset
UER46Q PRI70 71	privacy 2 3/4" backset
UER46Q DUM 71	full dummy
UER46Q DUML 71	half dummy left
UER46Q DUMR 71	half dummy right
UEDBQ 71	deadbolt to add to passage
UEDBQ A 71	deadbolt keyed alike

round

UER46 PAS60 71	passage 2 3/8" backset
UER46 PAS70 71	passage 2 3/4" backset
UER46 PRI60 71	privacy 2 3/8" backset
UER46 PRI70 71	privacy 2 3/4" backset
UER46 DUM 71	full dummy
UER46 DUML 71	half dummy left
UER46 DUMR 71	half dummy right
UEDB 71	deadbolt to add to passage
UEDB A 71	deadbolt keyed alike

specification details

lever

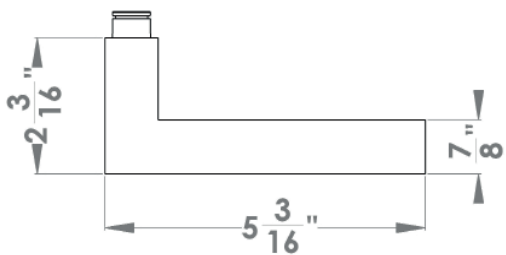

round rose

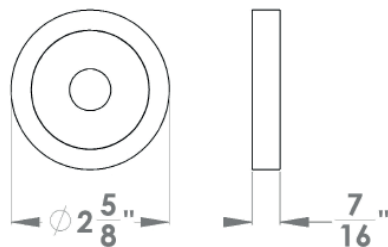

square rose

