



Manhattan

Finish: cosmos black (83)

Manhattan on rose, special door prep required



Manhattan – TER21Q
 2 1/16" x 2 1/16"



Manhattan – TER21
 Ø 2 1/16" x 7/16"

Features TER21Q and TER21

- 3 piece rose
- concealed bolt-through fixing
- sprung
- door range 1 1/2" (38 mm) - 1 7/8" (48 mm) standard
- stainless steel faceplate
- Accurate UL Listed Mortise Lock
- rate of satin stainless steel 304
- hub 5/16" (8 mm)
- available finishes: cosmos black, satin stainless steel

product code

square

TER21Q PRI 9139 83 Accurate privacy without cylinder
 TER21Q STORE 9195 83 Accurate storeroom/nitelatch
 TER21Q ENT 9167 83 Accurate entrance set;
 cylinder not included

TER21Q ENT 9169 83 Accurate entrance set;
 cylinder not included

UEZ1340 CC 83 cylinder collar
 UEZ1340 TT 83 thumbturn
 UEZ1340 BAD 83 privacy thumbturn

round

TER21 PRI 9139 83 Accurate privacy without cylinder
 TER21 STORE 9195 83 Accurate storeroom/nitelatch
 TER21ENT 9167 83 Accurate entrance set;
 cylinder not included

TER21 ENT 9169 83 Accurate entrance set;
 cylinder not included

UEZ1332 CC 83 cylinder collar
 UEZ1332 TT 83 thumbturn
 UEZ1332 BAD 83 privacy thumbturn

specification details

lever

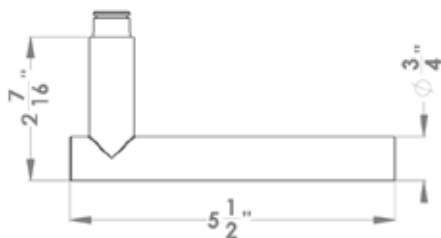

round rose



square rose

