

Tear Sheet
Model Gent on rose by KARCHER DESIGN

KARCHER
DESIGN

GERMANY

contact our US office
Karcher Design USA
Tukila, Seattle
+1 844 858 2033
order@karcher-design.com

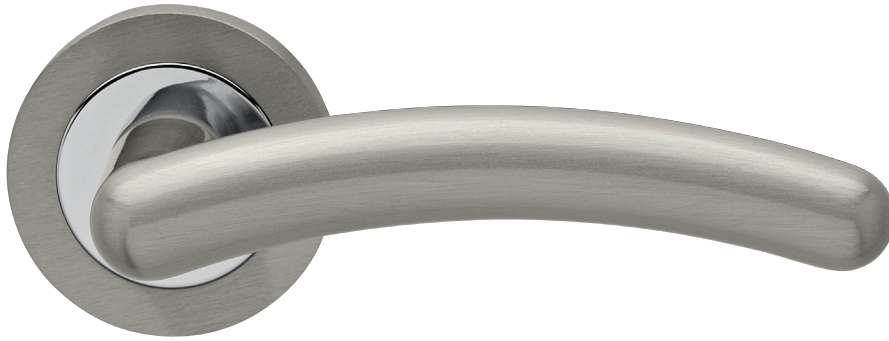

Gent

Finish: chrome/satin nickel (65)

To suit standard 2 1/8" door prep



Gent- UR 473
Ø 2 5/8 x 7/16"

product code
round

UR473 PAS60 65	passage 2 3/8" backset
UR473 PAS70 65	passage 2 3/4" backset
UR473 PRI60 65	privacy 2 3/8" backset
UR473 PRI70 65	privacy 2 3/4" backset
UR473 DUM 65	full dummy
UR473 DUML 65	half dummy left
UR473 DUMR 65	half dummy right
UEDB 73	deadbolt to add to passage
UEDBA 73	deadbolt keyed alike

Features UR473

- 3 piece rose
- concealed bolt-through fixing
- sprung
- door range 1 1/4" (31 mm) - 2" (51 mm) standard
- T- and Lip-Strike ith dust box
- stainless steel faceplate
- backsets: 2 3/8" (60 mm) or 2 3/4" (70 mm)
- functions: Passage (PAS), Privacy (PRI), full dummy (DUM), dummy left (DUM L), dummy right (DUM R)
- available with UL-Latch
- 28° latch with attached face plate
- rate of satin stainless steel 304
- hub 5/16" (8 mm)
- door prep 2 1/8"
- available finish: chrome/satin nickel

specification details

lever

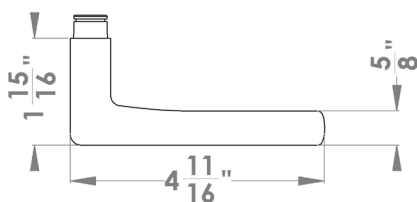

round rose

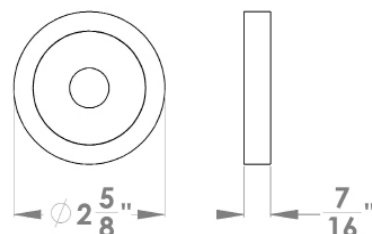

square rose

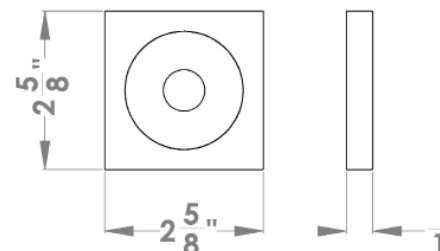

Please note: Karcher Design products are designed and measured in metric. Imperial measurements are close approximations to the actual metric dimensions