

Tear Sheet
Model Kioto on rose by KARCHER DESIGN

KARCHER
DESIGN

GERMANY

contact our US office
Karcher Design USA
Tukwila, Seattle
+1 844 858 2033
order@karcher-design.com



Kioto

Finish: satin stainless steel (71)

Features UER72Q and UER72

- 3 piece rose
- concealed bolt-through fixing
- sprung
- door range 1 1/4" (31 mm) - 2" (51 mm) standard
- T- and Lip-Strike with dust box
- stainless steel faceplate
- backsets: 2 3/8" (60 mm) or 2 3/4" (70 mm)
- functions: Passage (PAS), Privacy (PRI), full dummy (DUM), dummy left (DUM L), dummy right (DUM R)
- available with UL-Latch
- 28° latch with attached face plate
- rate of satin stainless steel 304
- hub 5/16" (8 mm)
- door prep 2 1/8"
- available finish: satin stainless steel



Kioto- UER 72Q
2 5/8 x 2 5/8 x 7/16"



Kioto - UER 72
Ø 2 5/8 x 7/16"

product code square

UER72Q PAS60 71	passage 2 3/8" backset
UER72Q PAS70 71	passage 2 3/4" backset
UER72Q PRI60 71	privacy 2 3/8" backset
UER72Q PRI70 71	privacy 2 3/4" backset
UER72Q DUM 71	full dummy
UER72Q DUML 71	half dummy left
UER72Q DUMR 71	half dummy right
UEDBQ 71	deadbolt to add to passage

round

UER72 PAS60 71	passage 2 3/8" backset
UER72 PAS70 71	passage 2 3/4" backset
UER72 PRI60 71	privacy 2 3/8" backset
UER72 PRI70 71	privacy 2 3/4" backset
UER72 DUM 71	full dummy
UER72 DUML 71	half dummy left
UER72 DUMR 71	half dummy right
UEDB 71	deadbolt to add to passage
UEDBA 71	deadbolt keyed alike

specification details

lever

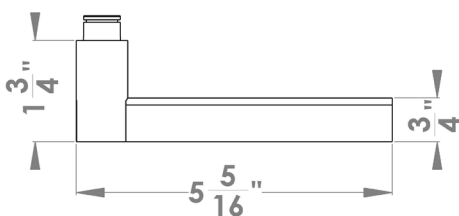

round rose

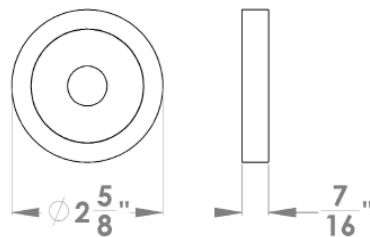

square rose

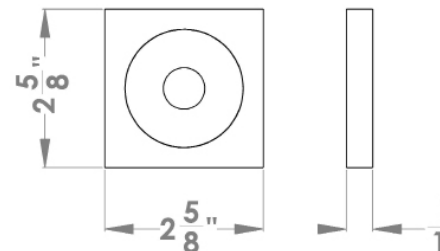

Please note: Karcher Design products are designed and measured in metric. Imperial measurements are close approximations to the actual metric dimensions